

3 needle, double chain stitch, feed-off the arm, denim lapseamer

# SX6803PD



3 needle, double chain stitch, feed-off the arm machine, with a puller and differential feeding system  
 ※Lap seam folder is included



## Features



1. Solutions for uneven stitches at cross section  
 upper puller, synchronized with feed dogs, gives most efficient feeding for thicker material

Sliding type folder helps operator to set fabric with ease

2. Prevent puckering and unstable stitches  
 Differential feed mechanism ensures prevents puckering

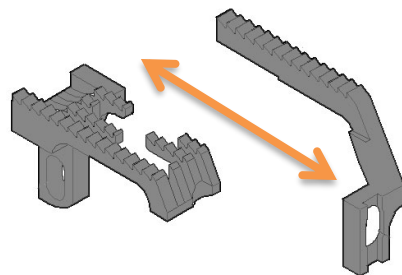

Model	Application	Material	Needle	No. of Threads	Gauge	Needle bar Stroke	Stitch length stitch/inch	Differential Feed ratio	Presser Foot lift	Maximum Speed
SX6803PD	Lap seam	Heavy	TVx3 21	6	1/4, 9/32	33.3mm	6-12mm	0.7-1.3	8mm	4500