

MADE IN JAPAN



KANSAI
SPECIAL

2 needle, double chain stitch, feed-off the arm, lap seam machine

SQ7702FB/PF/AF/DD

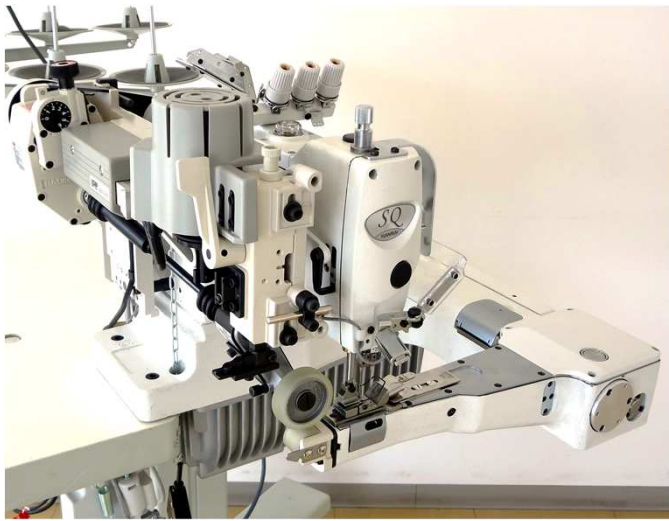

2 needle, double chain stitch, feed-off the arm machine, with a differential feeding system, rubber rear puller, pneumatic presser system and direct drive motor.



Features

Pneumatic presser foot



DLC coated Needle bar and oil seal achieve high speed

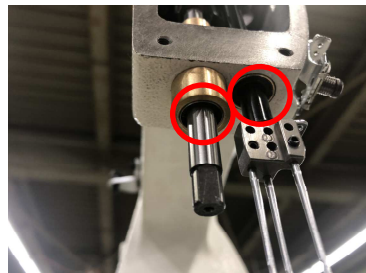

Rear puller device



Push button stitch length adjustment



Differential feed mechanism prevents puckering

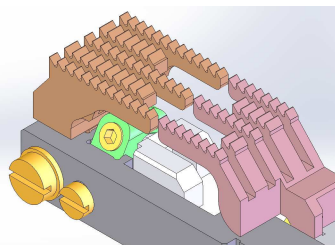

Full automatic lubrication with Oil filter



Direct motor

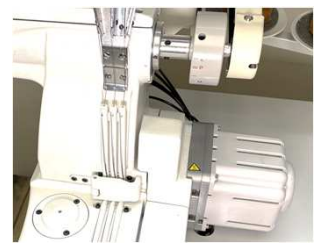

Model	Application	Material	Needle	No. of Threads	Gauge	Needle bar Stroke	Stitch length stitch/inch	Differential Feed ratio	Presser Foot lift	Maximum Speed
SQ7702FB /PF/AF/DD	Lap seam	Medium	UYx128GAS TVx3 #12	4	1/4" 3/16"	31.3mm	1.2-3.2mm 8-21/inch	0.7-1.3	10mm	5000